

SITE PLAN KEY NOTES

- 1 TRASH ENCLOSURE
- 2 (E) TREE TO BE REMOVED, SHOWN DASHED
- 3 (E) TREE(S) ON NEIGHBORING PROPERTY AND/OR PUBLIC RIGHT-OF-WAY
- 4 (E) TREE CANOPY
- 5 (E) 7'-0" WOOD FENCE TO REMAIN
- 6 (E) 6'-0" WOOD FENCE
- 7 (N) CONCRETE DRIVEWAY, ENCROACHMENT PERMIT REQUIRED IN RIGHT-OF-WAY
- 8 AN ENCROACHMENT PERMIT FROM THE ENGINEERING DIVISION IS REQUIRED PRIOR TO ANY CONSTRUCTION ACTIVITIES IN THE PUBLIC RIGHT OF WAY
- 9 (E) RESIDENCE & GARAGE TO BE REMOVED, SHOWN DASHED
- 10 HEAT PUMP CONDENSER
- 11 (E) WATER METER
- 12 (E) STREET SIGN
- 13 (E) UTILITY POLE
- 14 (E) CONCRETE CURB
- 15 CONCRETE PAVERS
- 16 NEIGHBORING BUILDING
- 17 NEIGHBORING DRIVEWAY
- 18 CHIMNEY / FLUE ENCLOSURE
- 19 SKYLIGHT
- 20 9'-6"x16'-6" UNCOVERED PARKING SPACE
- 21 TREE PROTECTION FENCING, SEE ARBORIST REPORT
- 22 (N) 48" BOX REPLACEMENT TREE, SPECIES: PISTACIA CHINENSIS (CHINESE PISTACHE), OR SIMILAR APPROVED SPECIES
- 23 NOT USED
- 24 10'-0"x20'-0" COVERED PARKING SPACE (SHOWN DASHED INSIDE OF DETACHED GARAGE)
- 25 (E) LANDSCAPING TO REMAIN, TYP.
- 26 6'-0" VERTICAL WOOD FENCE (U.O.N., SEE EXTERIOR ELEVATIONS)
- 27 (N) 24" BOX REPLACEMENT TREE, SPECIES: LAURUS NOBILIS (SARATOGA LAUREL), OR SIMILAR APPROVED SPECIES

TREES TO REMAIN (SEE ARBORIST REPORT):
 TREE #85: CALIFORNIA BAY, PROTECTED
 TREE #86: MULBERRY, PROTECTED
 TREE #87: WALNUT, PROTECTED

OVERHANGING TREE FROM NEIGHBORING PROPERTY (SEE ARBORIST REPORT):
 TREE #90: SOUTHERN MAGNOLIA, PROTECTED

TREES TO BE REMOVED UNDER SEPARATE PERMIT (SEE ARBORIST REPORT):
 TREE #88: PRIVET, PROTECTED
 TREE #89: HORSE CHESTNUT, PROTECTED

NOTE:
 SEE AREA PLAN, SHEET A1.3 FOR (E) FIRE HYDRANT AND (E) POWER POLE LOCATIONS

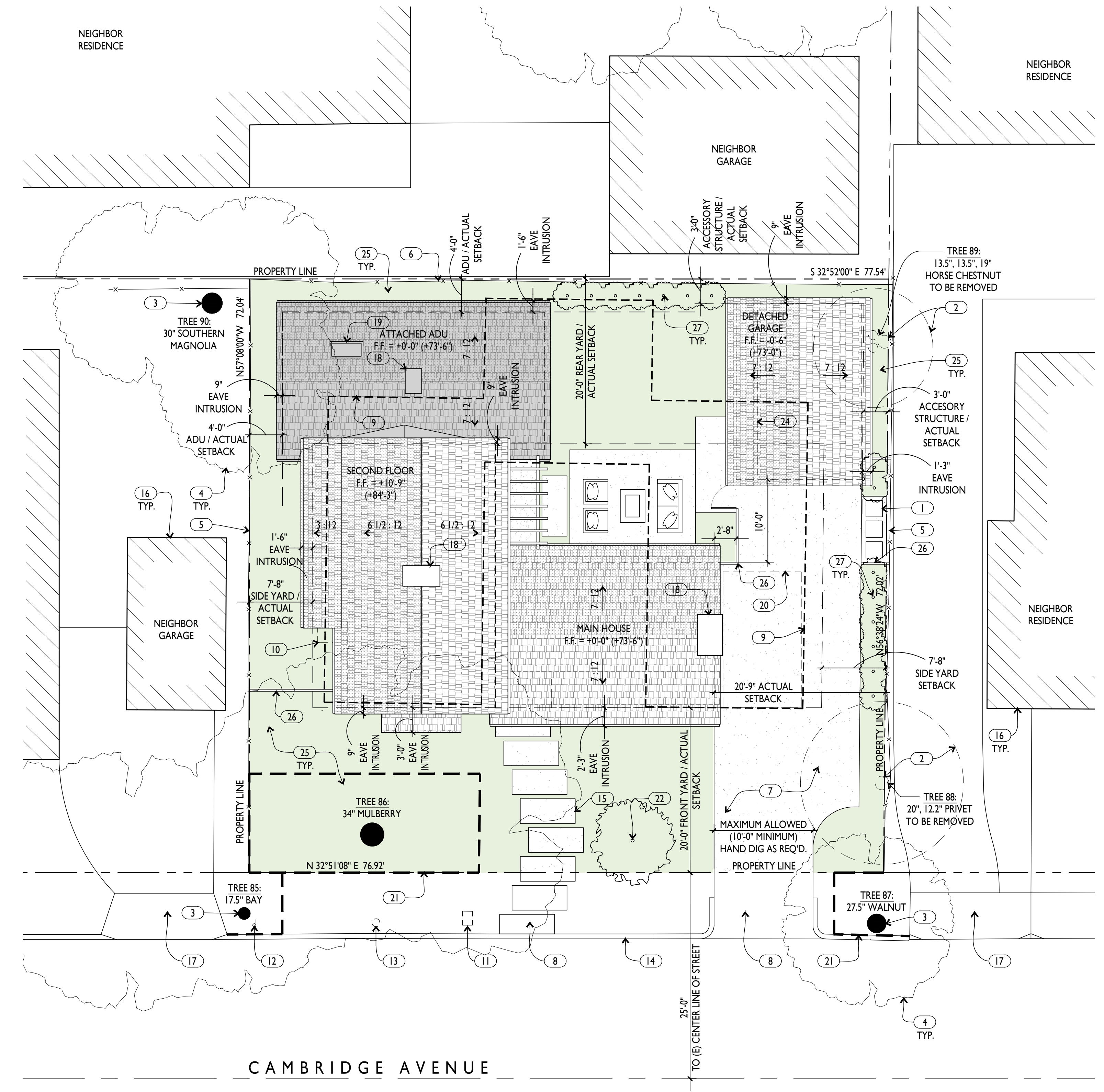

2 SITE / ROOF PLAN
A1.2



